

ITEM IDENTIFICATION : POLYTECH PLUS (WARRANTY CAPSULE IN MULTI-LAYER MATERIAL)

RAW MATERIAL DESCRIPTION

Composition: multi-layer sheet in aluminium-polyethylene-aluminium (polylaminare), non-toxic and suitable for food contact

Capsule's body material : polylam sheet with standard average thickness 20 - VII - 20

Thickness: 20 - VII - 20 polylaminare obtained through direct coupling by co-extrusion of 5 different materials layers, without using additives:

- annealed aluminium sheet: thickness $20\mu (\pm 8\%)$;
- extrusion of polyethylene at low density: $70 \pm 6 \text{ g/m}^2$;
- annealed aluminium sheet: thickness $20\mu (\pm 8\%)$.

TECHNICAL PARAMETERS - RAW MATERIAL

CARACTERISTIC	AVERAGE VALUE	UNIT OF MEASUREMENT	TOLERANCE	TRIAL METHOD
Weight	180	g/m^2	$\pm 10 \%$	ISO 536
Thickness	130	μm	$\pm 12,5 \%$	ISO 534
Use	still wine capsule			
Mechanical characteristics	maximum tensile stress $R_m \geq 170 \text{ MPa}$ referred to 15 mm, stretching $A_{100\text{mm}} \geq 6\%$			DIN EN 546-2
Steam permeability	$\mu > 1.000.000$			
Thermal conductivity	0.35	W/mK (a 10°C)		UNI EN 12664
Security information	<ul style="list-style-type: none"> - chemical composition: in compliance with the UE Directive 94 / 62 / EC. All the elements Cd-Hg-Pb-Cr are inferior to 100 ppm; - food suitability in compliance with the Directive 2004 / 1935 / EC, the standards EN 602 of 2004; - 100% recyclable and regenerable in compliance with D.Lgs 22 del 5 / 2 / 1997; - aromatic content $\leq 200 \text{ ppm}$; - non dangerous according to the Directives 1999 / 45 / CE and 67 / 548 / CE; - chemically stable and inert up to 250°. 			

PHYSICAL PARAMETERS - DIMENSIONAL CARACTERISTICS

Capsule height: from 40 mm to 70 mm ($\pm 1 \text{ mm}$)	Average weight: 1,148 g (referred to the standard size 29.3x55 $\alpha=0^\circ 50'$)
Capsule diameter: from 27 mm to 34 mm ($\pm 0,5 \text{ mm}$)	Body colour: according to the Intercap catalogue or customized
Conicity: from $0^\circ 50'$ to $3^\circ 54'$	Top colour: according to the Intercap catalogue or customized

Technical artwork concerning the standard size 29,3x55



Testa preformata standard
Standard preformed head



Anello di separazione
Separation ring

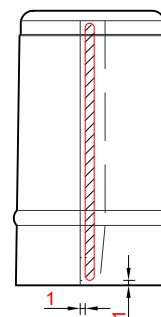
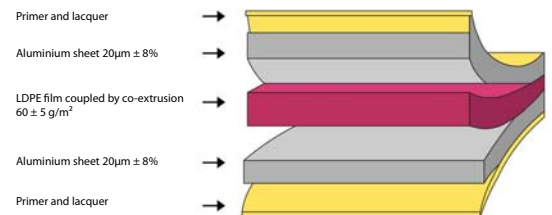

TOLERANCES:

- glue on side $1\text{mm} \pm 1\text{mm}$;
- glue at the base $1\text{mm} \pm 1\text{mm}$.

Date
21/10/2014

Designer
Alessandra Cicgoi

Quality Ass. Manager
G. Morando / L. Cantarella

Production Manager
Enrico Gallese