

### ITEM IDENTIFICATION : TINHYBRID (WARRANTY CAPSULE IN MULTI-LAYER MATERIAL)

#### RAW MATERIAL DESCRIPTION

Composition: multi-layer sheet in aluminium-polyethylene-aluminium (polylaminare), non-toxic and suitable for food contact

Capsule's body material : polylam sheet with standard average thickness 30 - V - 30

Thickness: 30 - V - 30 polylaminare obtained through direct coupling by co-extrusion of 5 different materials layers, without using additives:

- annealed aluminium sheet: thickness  $30\mu$  ( $\pm 8\%$ );
- extrusion of polyethylene at low density:  $60 \pm 5$  g/m<sup>2</sup>;
- annealed aluminium sheet: thickness  $30\mu$  ( $\pm 8\%$ ).

#### TECHNICAL PARAMETERS - RAW MATERIAL

| CARACTERISTIC              | AVERAGE VALUE  | UNIT OF MEASUREMENT | TOLERANCE    | TRIAL METHOD |
|----------------------------|--|---------------------|--------------|--------------|
| Weight                     | 250  | g/m <sup>2</sup>    | $\pm 10\%$   | ISO 536      |
| Thickness                  | 140  | $\mu$ m             | $\pm 12,5\%$ | ISO 534      |
| Use                        | still wine capsule   |                     |              |              |
| Mechanical characteristics | maximum tensile stress $R_m \geq 170$ MPa referred to 15 mm, stretching $A_{100mm} \geq 6\%$   |                     |              | DIN EN 546-2 |
| Steam permeability         | $\mu > 1.000.000$  |                     |              |              |
| Thermal conductivity       | 0.35   | W/mK (a 10° C)      |              | UNI EN 12664 |
| Security information       | <ul style="list-style-type: none"> <li>- chemical composition: in compliance with the UE Directive 94 / 62 / EC. All the elements Cd-Hg-Pb-Cr are inferior to 100 ppm;</li> <li>- food suitability in compliance with the Directive 2004 / 1935 / EC, the standards EN 602 of 2004;</li> <li>- 100% recyclable and regenerable in compliance with D.Lgs 22 del 5 / 2 / 1997;</li> <li>- aromatic content <math>\leq 200</math> ppm;</li> <li>- non dangerous according to the Directives 1999 / 45 / CE and 67 / 548 / CE;</li> <li>- chemically stable and inert up to 250°.</li> </ul> |                     |              |              |

#### PHYSICAL PARAMETERS - DIMENSIONAL CARACTERISTICS

|   |   |
|---|---|
| Capsule height: from 40 mm to 70 mm ( $\pm 1$ mm)     | Average weight: 1,367 g (referred to the standard size 29.3x55 $\alpha=0^\circ 50'$ ) |
| Capsule diameter: from 27 mm to 34 mm ( $\pm 0,5$ mm) | Body colour: according to the Intercap catalogue or customized                        |
| Conicity: from $0^\circ 50'$ to $3^\circ 54'$         | Top colour: according to the Intercap catalogue or customized                         |

#### Technical artwork concerning the standard size 29,3x55



Testa preformata standard  
Standard preformed head



Anello di separazione  
Separation ring

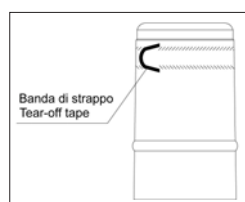

Banda di strappo  
Tear-off tape

On request, it's possible to add the easy opening "Cognac-type"

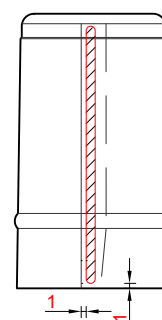
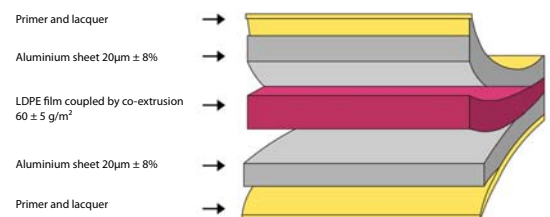

TOLERANCES:

- glue on side 1mm  $\pm 1$ mm;
- glue at the base 1mm  $\pm 1$ mm.

Date  
21/10/2014

Designer  
Alessandra Cicigoi

Quality Ass. Manager  
G. Morando / L. Cantarella

Production Manager  
Enrico Gallese